



191537000-2023



Becker County Planning & Zoning  
915 Lake Ave  
Detroit Lakes, MN 56501  
(218) 846-7314  
www.co.becker.mn.us

# Certificate of Compliance

## Inspection Report - Permit #: SS2023-1778

### Owner & Property Information

Owner Name:	GREGORY COOPER	Site Address:	14259 W LAKE SALLIE DR
Mailing Address:	GREGORY COOPER 14259 WEST LAKE SALLIE DR DETROIT LAKES MN 56501	Township - Sec/Twp/Rng:	LAKE VIEW - 07/138/041
Parcel #:	191537000	Legal Description:	OAK GROVE 138 41 LOTS 21 AND 22 & VACATED DRIVE.
Secondary Parcel #:		Designer:	Dewey's Septic Service LLC, L2884 (Timothy Smith)
		Installer:	Dewey's Septic Service LLC, L2884 (Timothy Smith)

### Inspector Verified Specifications

Insp- Effluent Screen Installed:	No	Insp- Tank Nbr/Size:	1/1500/2
Insp- Alarm Required:	No	Insp- Drainfield Type:	Chamber Trench
Insp- Lift Pump in System:	No	Insp- Drainfield Size:	existing 375 sq ft
Insp- Number of Bedrooms:	3	Insp- Soil Verification:	#1:N/A #2:N/A #3:N/A

### Inspector Verified Setbacks

Insp- Tank Dist to Road	40+	Insp- Drainfield Dist to Road	
Insp- Tank Dist to Nearest Prop Line	10+	Insp- Drainfield Dist to Nearest Prop Line	
Insp- Tank Dist to Nearest Structure	50+	Insp- Drainfield Dist to Nearest Structure	
Insp- Tank Dist to Well	50+	Insp- Drainfield Dist to Well	
Insp- Tank Dist to OHW	150+	Insp- Drainfield Dist to OHW	existing
Insp- Tank Dist to Pond/Wetland		Insp- Drainfield Dist to Pond/Wetland	
Insp- Tank Dist to Pressure Line		Insp- Drainfield Dist to Pressure Line	

### Certificate of Compliance

(Yes) Certificate is hereby granted based upon the application, addendum from, plans, specifications and all other supporting data. With proper maintenance, this system can be expected to function satisfactory, however this is not a guarantee.

Certification Date: 07/19/2023

Zoning Office Signature:

Denise Gubrud - ISTS Inspector

\* Certificate of Compliance is not valid unless signed by a Registered Qualified Employee \*

# Field Review Form

Permit # SS2023-1778

## Property and Owner

Owner: GREGORY COOPER	Parcel Number: 191537000
Site Address: 14259 W LAKE SALLIE DR	Secondary Parcel:

## Home Information

Does the structure contain any of the following elements?	Designer submitted	Inspector verified
	Garbage disposal: Yes Dishwasher: Grinder pump: Lift pump in bsmt:	Garbage disposal? <input checked="" type="checkbox"/> N Dishwasher? Y <input checked="" type="checkbox"/> Grinder pump? Y <input checked="" type="checkbox"/> Lift pump in basement? Y <input checked="" type="checkbox"/>
Number of bedrooms: 3	Review - Number of bedrooms: 3	
Effluent screen	Effluent screen installed? Y <input checked="" type="checkbox"/> Mfr:	
Alarm: No Type:	Review - Alarm? Y <input checked="" type="checkbox"/> Type & Mfr:	
Lift pump in system: No	Review - Lift pump in system? Y <input checked="" type="checkbox"/> Mfr:	

## Component Information

Tank size: 1500	Review - Tank nbr: 1 size: 1500/2 Mfr: Brown
Drainfield type:	Review - Drainfield type: existing trenches
Drainfield size: Full size - Reduced/warr. size -	Review - Drainfield status: none / installed / next spring Review - Drainfield size:
Absorption area size:	Review - Absorption area size:
Chamber type/num: Trench sqft/chamber -	Review - Chamber type: existing Review - Trench sqft/chamber: existing Num:
Drainfield rock depth:	Review - Rock depth:

## Soil Verification

Vertical separation verified	Boring #1: Boring #2: Boring #3:
	existing

## Setback Verification

Distance to...	Designer submitted		Inspector verified	
	Tank	Drainfield	Tank	Drainfield
Road	40+	10+	40+	
Nearest prop line	10+	10+	10+	
Nearest structure	50+	100	50+	
Well	50+	100	50+	
OHW	150+	150+	150+	
Pond/Wetland				
Pressure line	20	20		

Date System Installed: 7/19/2023 Installer: Dewey's Inspector: Denise Gabriel

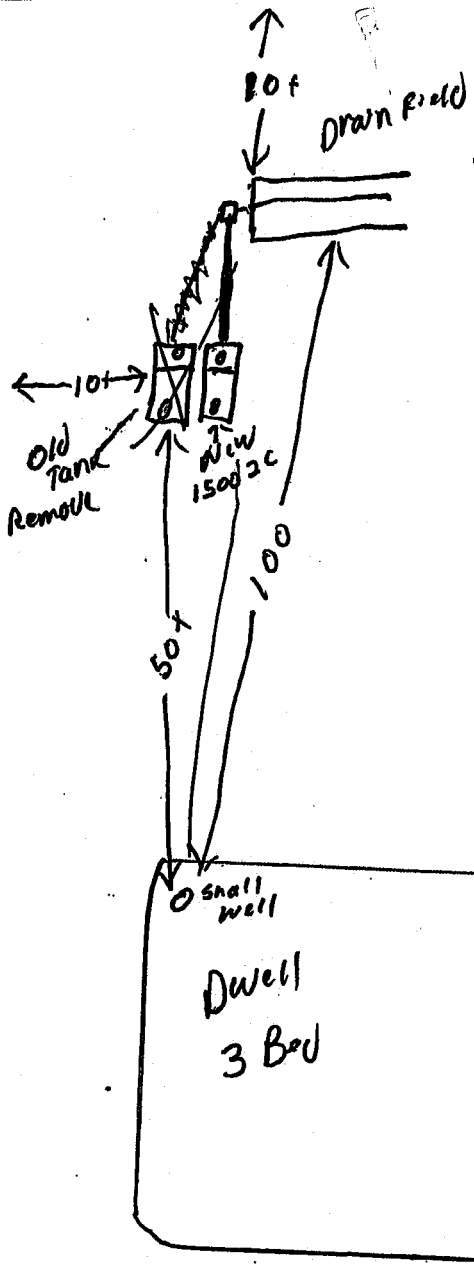

14259 W Lake Sattler Dr  
 1500/2C Brown  
 Dewey's  
 375 sq ft drain field

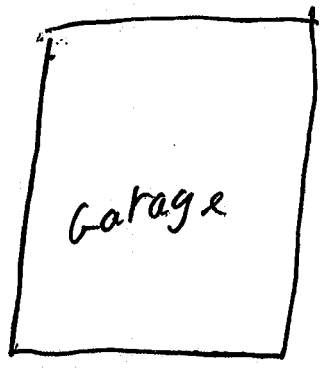
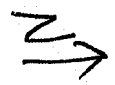

7-19-2023  
 1500/2 Brown  
 to gravity trenches  
 cert by  
 Denise Gubrud

*DMG*

FOR LAKE



Becker County Planning & Zoning  
 915 Lake Ave  
 Detroit Lakes, MN 56501  
 (218) 846-7314  
 www.co.becker.mn.us

# Septic Permit

Permit #: SS2023-1778

Owner & Property Information			
Owner Name:	GREGORY COOPER	Parcel #:	191537000
Mailing Address:	GREGORY COOPER 14259 WEST LAKE SALLIE DR DETROIT LAKES MN 56501	Secondary Parcel #:	
Phone #:	na	Site Address:	14259 W LAKE SALLIE DR
Lake/River(1000/300):	Yes	Township - Sec/Twp/Rng:	LAKE VIEW - 07/138/041
Lake/River Name:	Fox (Lake View) [RD]	Designer:	Dewey's Septic Service LLC, L2884 (Timothy Smith)
Pond/Wetland(50):	No	Installer:	Dewey's Septic Service LLC, L2884 (Timothy Smith)

Specifications			
Tank to be Installed:	Compartmented Tank	Type of Drainfield:	
Total # Tanks Installed:	1	Full Size of Drainfield:	
System Status:	Repairs Needed to Existing	Reduced/Warrantied Size:	
System Serves:	Full-Time Dwelling	Absorbtion Area Size:	
Number of Bedrooms:	3	Rock Depth:	
Design Flow/GPD:	450	Chamber Type and Number:	
Garbage Disposal?	Yes	Chamber Trench SqFt/Chamber:	
Size of Lift Pump:		Is System Pressurized?	
Size of Lift Line:		Alarm?	No
Soil Sizing Factor:		Type of Alarm:	

Setbacks			
Road Type:	Public / Township	Right of Way Marked:	Yes
Tank Dist to Road:	40+	Drainfield Dist to Road:	10+
Tank Dist to Closest Prop Line:	10+	Drainfield Dist to Closest Prop Line:	10+
Tank Dist to Nearest Structure:	50+	Drainfield Dist to Nearest Structure:	100
Tank Dist to Well:	50+	Drainfield Dist to Well:	100
Tank Dist to OHW:	150+	Drainfield Dist to OHW:	150+
Tank Dist to Pond/Wetland:		Drainfield Dist to Pond/Wetland:	
Tank Dist to Pressure Line:	20	Drainfield Dist to Pressure Line:	20

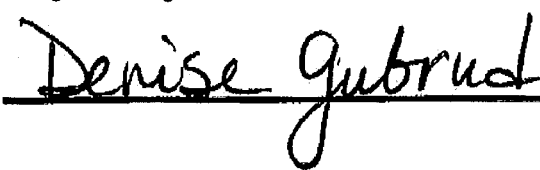
Other Information		Zoning Office Signature:
Date Approved:	07/19/2023	
Permit Fee:	\$225.00	
Receipt Number:	253153354	
Date Paid:	07/19/2023 4:26 PM CDT	
Notes:	Install a replacement septic tank 1500/2	

PERMIT MUST BE POSTED AT JOB SITE. PERMIT EXPIRES ONE YEAR FROM DATE PAID.

\*\* Please schedule for inspection prior to installation! \*\*